

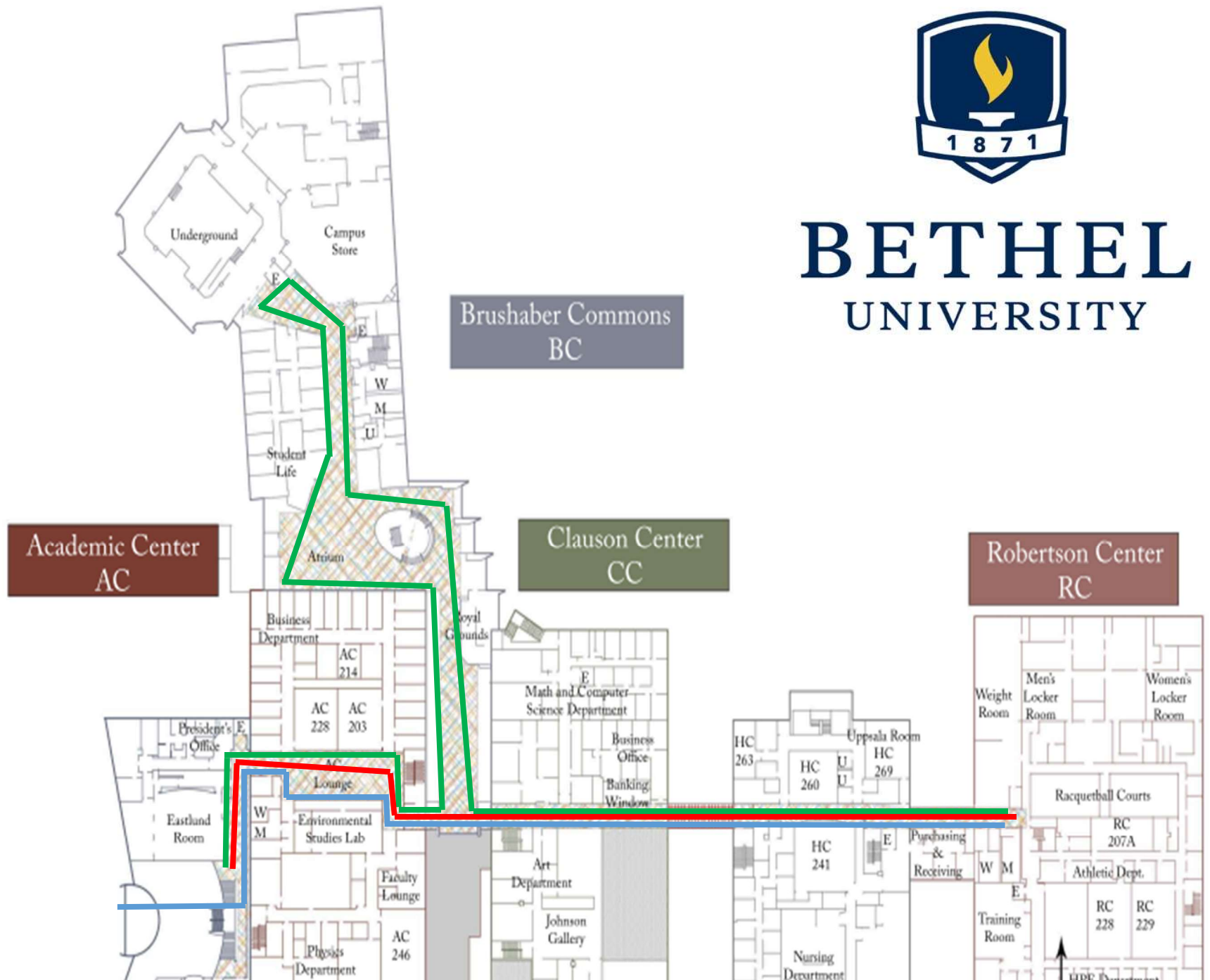

# BETHEL UNIVERSITY



Brushaber Commons  
BC

Academic Center  
AC

Clauson Center  
CC

Robertson Center  
RC

### Blue Path

- The blue path is on the first floor level and starts at the PO's and finishes at the CLC doors in the main lobby
- Approximately 500 Feet
- 1 Mile = 10.5 trips one way

### Green Path

- The green path is the same for both the second and third floor
- The second floor starts at the steps by the athletic reception area, goes through the BC commons to the bookstore and back through the AC building and ends at the steps leading down to the CLC
- The third floor starts at the RC door, goes to the BC commons balcony to the DC and back and ends at the entrance to the AC building
- Approximately 730 Feet
- 1 Mile = 7.25 trips one way

### Red Path

- The red path is the same for both the second and third floor
- The second floor starts at the steps by the athletic reception area and goes to the stairs leading down to the CLC
- The third floor starts at the RC door and goes to the entrance of the AC building
- Approximately 480 Feet
- 1 Mile = 11 trips one way

### Multi-Floor Path 1

- This path starts at the PO's and goes to the CLC, up the stairs to the BC commons to the bookstore and back, to the athletic reception area, up the stairs to the RC door, to the BC balcony, to the DC and back than to the AC building entrance
- (Blue path + 2<sup>nd</sup> floor Green path + 3<sup>rd</sup> floor Green path)
- Approximately 1,960 Feet
- 1 Mile = 2.75 trips one way

### Multi-Floor Path 2

- This path starts at the PO's and goes to the CLC, up the stairs and to the athletic reception area, up the stairs to the RC door, to the AC building entrance
- (Blue path + 2<sup>nd</sup> floor Red path + 3<sup>rd</sup> floor Red path)
- Approximately 1,460 Feet
- 1 Mile = 3.75 trips one way

### Multi-Floor Path Avoiding outside

- This path starts at the PO's and goes to the CLC lobby, up the stairs to the AC building, up those stairs to the 3<sup>rd</sup> floor AC than to the RC door
- (Blue path + 3<sup>rd</sup> floor Red path)
- Approximately 980 Feet
- 1 Mile = 5.5 trips one way

\*To avoid going outside do not use the green or red paths on the second floor



# Academic Building Walking Paths

